

Kurume City Plaza

Facilities Guide

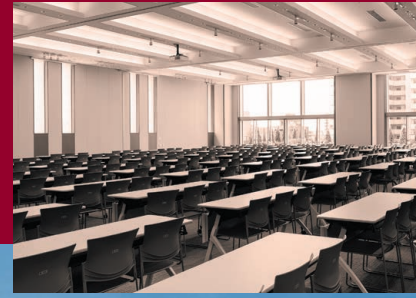

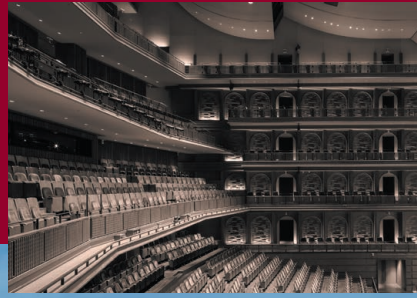

The Grand Hall

Kurumeza Theatre

Creative Box

Rokkakudo Square

A Place Where Culture and Community Thrive

Kurume City Plaza is a cultural exchange center located at the heart of Kurume City in the Fukuoka Prefecture. As a key hub for the southern region, it sits next to the Kurume Hotomeki Street shopping district. Established in April 2016, the plaza serves as a vibrant new landmark, bringing people together through arts and culture. With a wide range of events and initiatives, it provides opportunities to experience both local and international culture. The plaza also actively promotes MICE (Meetings, Incentives, Conferences, and Exhibitions), working alongside the community to showcase and cultivate Kurume's unique character and cultural appeal. Our goal is to be a welcoming space that is loved by all.

FLOOR MAP

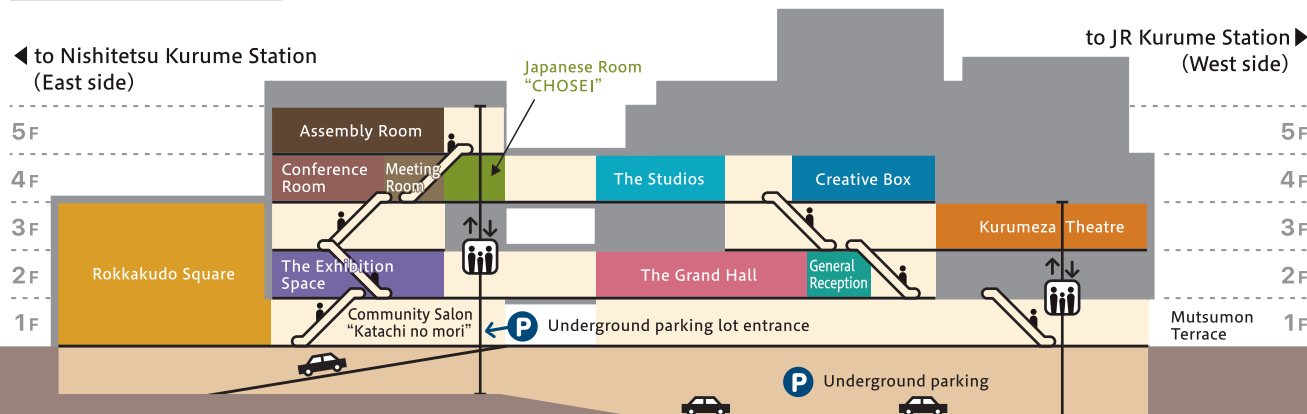

Features of each facility			Capacity		
Facility name	Number of rooms	Floor area[approx.](㎡)	Theatre Style	Seminar style	Other style
The Grand Hall	1	—	1,514	—	—
Kurumeza Theatre	1	—	399	—	—
Creative Box	1	—	144	—	—
Rokkakudo Square	1	1,320	—	—	—
The Studios	4	61/105/105/67	43/74/74/47	24/45/45/24	—
The Exhibition Space	1	430	300	198	215(exhibitions)
▶(Divided use)	3	133/132/165	90/90/116	48/72/72	66/66/83
Assembly Room/	3	L 530/M 240/S 130	L 378/M 165/S 91	L 300/M 120/S 60	—
L·Conference Room/	L 3	L 209/174/201	L 133/113/131	L 90/90/90	—
M·Meeting Room/S	M 3	M 73/ 77/ 96	M 54/ 52/ 55	M 30/30/42	—
▶(Divided use)	S 3	S 45/ 45/ 40	S 32/ 32/ 29	S 21/18/21	—
Japanese Room "CHOSEI"	1	138	—	—	50
▶(Divided use)	3	—	—	—	—
Community Salon "Katachi no mori"	1	310	—	—	—

Building Outline

Building area : 9,337.76㎡
 Total floor area : 34,548.33㎡
 Site area : 10,672.36㎡
 Floors :
 6 floors above ground and 2 basement floors
 Building height : 40.15m



◆ Number of seats

Total: 1,514 seats/Fixed seats: 1,500 seats
 1st tier: 808 seats/
 When the orchestra pit is installed: 648 seats
 (10 wheelchairs seats, 2 seats in multipurpose room)
 2nd tier: 262 seats (2 seats in multipurpose room)
 3rd tier: 228 seats 4th tier: 216 seats

◆ Stage dimensions

Width: approx. 18.2m
 Height: (gridiron height): approx. 31.8m
 Depth: approx. 18.2m

◆ Stage facilities

Orchestra pit
 Sound reflector
 (corresponding to both large and small orchestra)
 Movable proscenium 31 batons
 3 bridges Sliding stage
 Temporary hanamichi

◆ Stage Styles

Proscenium Large orchestra (Sound reflector)
 Small orchestra (Sound reflector)

◆ Dressing rooms

6 private rooms
 2 middle-sized rooms (approx. 10 people)
 2 large-sized rooms (approx. 20 people)

◆ Reverberation time

Vacant
 2.26 seconds/Full house 2.02 seconds
 (Orchestra Shell in use)

2F Every moment brings the perfect sound The Grand Hall

Designed primarily for music, this hall offers outstanding acoustics and a rich, immersive sound experience. Its four-tiered seating arrangement and spacious design enhance the depth and clarity of every performance. The hall is equipped with extensive stage facilities, including an orchestra pit and a temporary hanamichi (runway stage), making it suitable not only for classical concerts but also for operas, musicals, kabuki performances, and MICE events. With the farthest seat just 30 meters from the stage, the hall provides an intimate connection between performers and the audience. The seats, designed for comfort, feature a generous width of 54 cm, ensuring a relaxed and enjoyable experience.

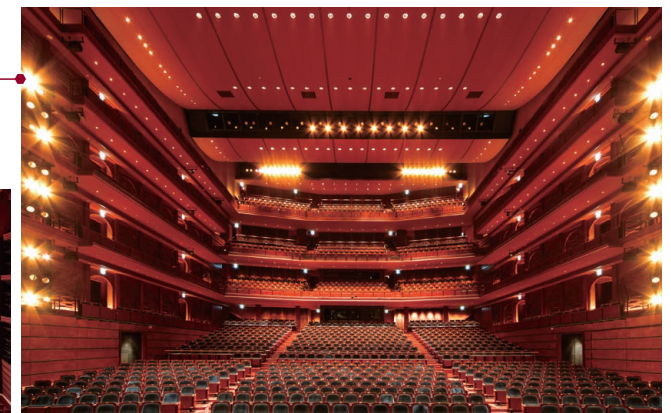



Blends quality with comfort **3F** Kurumeza Theatre

A Hall with Extensive Stage Facilities.
This versatile hall is ideal for a wide range of performances, including theater, dance, concerts, lectures, and ceremonies. It features a traditional Noh stage (a traditional Japanese stage) with waki-kensho (side stage areas), allowing for authentic Noh performances. Additionally, masuseki (Box Seats) are available on both sides of the first-floor seating area, enhancing the viewing experience.

◆Number of seats

Total: 399 seats/Fixed seats: 369 seats
1st tier: 317 seats
(2 wheelchairs seats, 30 box seats)
2nd tier: 82 seats (standing room for 24, 4 seats in the multipurpose room)

◆Stage dimensions

Width: approx. 12.7m
Height: (gridiron height) approx. 18.7m
Depth: approx. 11.2m

◆Stage facilities

Movable floor (stage and part of auditorium)
24 batons
3 suspension light batons
2 batons (lighting baton)
Temporary Stage for Noh performance

◆Dressing rooms

2 private rooms
3 middle-sized rooms (approx. 10 people)



4F A flexible space for creativity in all forms Creative Box

The small hall offers a highly adaptable space with adjustable flooring to accommodate various layouts.

By removing the seating, the entire area can be converted into a flat stage, making it suitable for a variety of performances. It can function as a black box theater for intimate productions or open up to offer a scenic view of Meiji Street.

This multi-purpose space is ideal for theater, dance, music performances, rehearsals, and seminars.

◆Number of seats

144 seats (2 wheelchairs seats)

◆Stage dimensions

As a parquet style: approx. 300sqm
(approx. 10.9m × approx. 21.6m)
Width: approx. 10.9m
Height: approx. 7.2m (under bridge)
Depth: approx. 9.1m

◆Stage facilities

Adjustable floor (stage and part of seating)
4 fly batons

◆Dressing rooms

2 middle-sized rooms (approx. 10 people)





A welcoming plaza to relax or connect **1F**

Inheriting its name from the previous Rokkakudo Square, which was cherished for many years, this open-air plaza features a membrane roof, allowing it to be used even in rainy weather. Located along the shopping district, it serves as a vibrant venue for various events, taking full advantage of its open and welcoming atmosphere. On days without scheduled events, it transforms into a relaxing gathering spot for visitors.



- ◆ **Floor area**
approx.1,320m²(For rent 1,043m²)
- ◆ **Facilities**
Elevating stage (9m×6m)
Electric and plumbing installation
- ◆ **Ceiling height**
average approx.17.5m

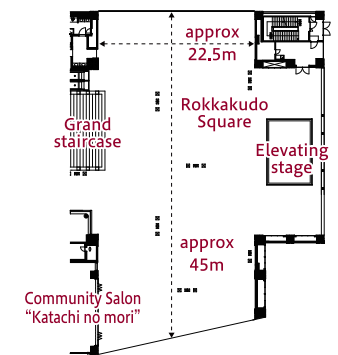

2F Striking exhibitions that rise through the open atrium

The Exhibition Space

Designed to accommodate a wide range of exhibitions-including art, calligraphy, trade shows, and more-this space offers flexible presentation options. Ceiling batons allow for lighting and signage to be suspended, while display panels and tables can be arranged in different layouts to suit various needs. The space can also be divided into three sections, providing even greater adaptability for different events.

◆ **Floor area**

Integrated Use/approx.430m²
Divided Use/Gallery1:approx.133m²
Gallery2:approx.132m²
Gallery3:approx.165m²

◆ **Capacity (people)**

Integrated Use/Exhibitions:215
Theater style:300
Seminar style:198

Divided Use/

Gallery1:Exhibitions:66
Theater style:90
Seminar style:48
Gallery2:Exhibitions:66
Theater style:90
Seminar style:72
Gallery3:Exhibitions:83
Theater style:116
Seminar style:72

◆ **Specification**

Floor load:270kg/sqm
Floor finish:Tile carpet
Ceiling:Picture rails

◆ **Ceiling height**

Gallery1and2:approx.4.5m
Gallery3:approx.7m

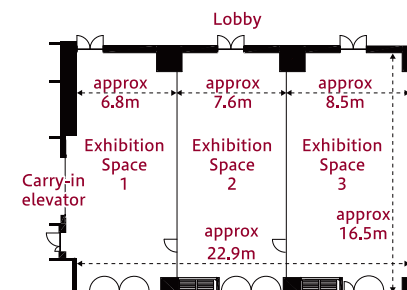



Assembly Room

4-5F

From casual clubs to major conventions—space that adapts to you

Assembly Room / Conference Room / Meeting Room

The large, medium, and small meeting rooms can each be divided into three sections, allowing for flexible space arrangements to suit different needs. These rooms are ideal for meetings, seminars, and can also be used as green rooms for events.



Conference Room



Meeting Room

Assembly Room

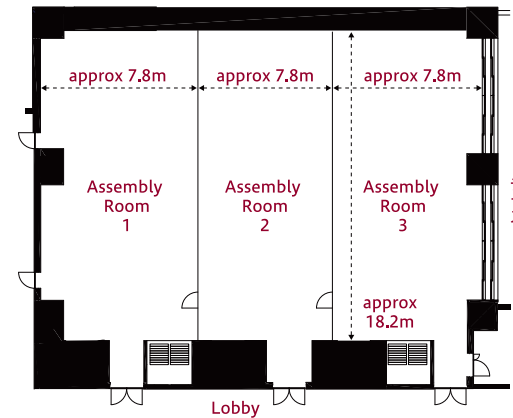

◆Floor area

Integrated Use/approx.530m²
Divided Use/Assembly Room1:approx.209m²
Assembly Room2:approx.174m²
Assembly Room3:approx.201m²

◆Capacity (people)

Integrated Use/Theater style 378
Seminar style 300
Divided Use/
Assembly Room1:Theater style 133
Seminar style 90
Assembly Room2:Theater style 113
Seminar style 90
Assembly Room3:Theater style 131
Seminar style 90

Conference Room

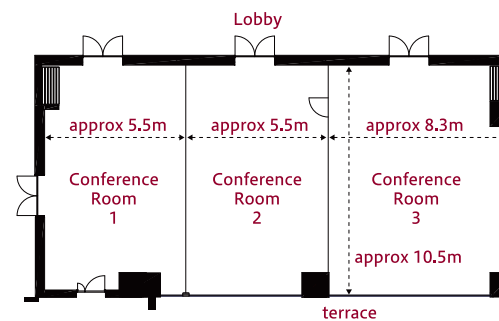

◆Floor area

Integrated Use/approx.240m²
Divided Use/Conference Room1:approx.73m²
Conference Room2:approx.77m²
Conference Room3:approx.96m²

◆Capacity (people)

Integrated Use/Theater style 165
Seminar style 120
Divided Use/
Conference Room1:Theater style 54
Seminar style 30
Conference Room2:Theater style 52
Seminar style 30
Conference Room3:Theater style 55
Seminar style 42

Meeting Room

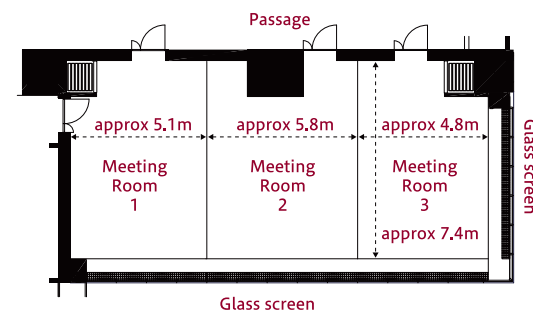

◆Floor area

Integrated Use/approx.130m²
Divided Use/Meeting Room1:approx.45m²
Meeting Room2:approx.45m²
Meeting Room3:approx.40m²

◆Capacity (people)

Integrated Use/Theater style 91
Seminar style 60
Divided Use/
Meeting Room1:Theater style 32
Seminar style 21
Meeting Room2:Theater style 32
Seminar style 18
Meeting Room3:Theater style 29
Seminar style 21



4F A dignified Japanese room for celebrating tradition Japanese Room “CHOSEI”

Each of the three kyoma (traditional Japanese tatami rooms) are the size of eight tatami mats (12.4 meters squared) and are equipped with a small tea stove that allows for charcoal or gas. These rooms are ideal for tea ceremonies, practice sessions, and gatherings. With a tea preparation area, kitchen, and garden path, the space can be expanded into a large 30-tatami-mat (37.2 meters squared) hall by removing the sliding doors, making it perfect for various traditional Japanese cultural events. It can also be used for workshops featuring low tables.

◆Floor area
approx.138m²
(three rooms with 8-tatami)

◆Capacity(people)
50

◆Facilities
2alcoves “toko-no-ma”
3Japanese style fireplaces “ro”
Preparation area “mizuya”
and kitchen
Japanese-style garden

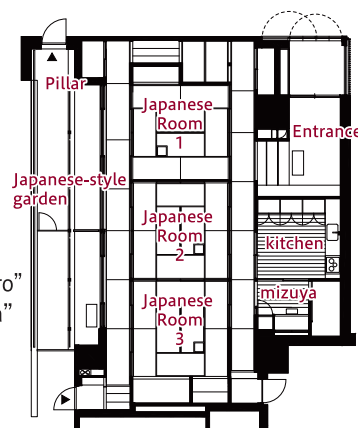

4F Whether you're chasing dreams or enjoying a hobby—it's your space The Studios

Designed with excellent soundproofing and acoustic insulation, these rooms provide an ideal environment for music and dance practice. The floors are covered with ballet mats, and one wall features a full-length mirror. The rooms can also be used for meetings and seminars.

◆Floor area
Studio1:approx.61m² Studio2・3:approx.105m²
Studio4:approx.67m²

◆Capacity(people)
Studio1:Theater style 43 Seminar style 24
Studio2・3:Theater style 74 Seminar style 45
Studio4:Theater style 47 Seminar style 24

◆Specification Floor:Ballet mat Wall:All-mirror
desk 1, chair20 Studio1・4:Digital piano (charged)
Studio2:Upright piano (charged)

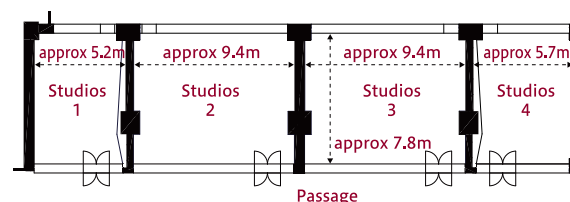

1F A Comfortable, Casual Gathering Space Community Salon “Katachi no mori”

This welcoming space, designed by the art unit tupera tupera, is both stylish and inviting, offering easy access from the shopping district. It features a nursing room and an all-ages restroom, creating a relaxing environment where people of all generations—from children to adults—can gather and unwind.

◆Floor area approx.310m²
◆Facilities Nursing room Multipurpose toilet



1F A Green Oasis for Rest and Relaxation Mutsumon Terrace

Located at the western entrance of Kurume City Plaza, this peaceful green space features the symbolic tree from the former Rokkakudo Plaza. With permanently installed tables, chairs, and benches, it can be enjoyed as an open-air café. During winter, the illuminated decorations add a special charm to the atmosphere.

※This is not a space for rent.



Kurume City Plaza

8-1 Mutsumon-machi, Kurume-city,
Fukuoka, 830-0031, Japan
TEL +81-942-36-3000
FAX +81-942-36-3087
URL <http://kurumecityplaza.jp>



Access

To Nishitetsu Kurume Station
[By taxi]approx.4min [By Bus]approx.5min
[By walking]approx.10min
To JR Kurume Station
[By taxi]approx.7min [By Bus]approx.10min
[By walking]approx.20min

Google
MAP



Opening Hours & Facility Information

■Opening Hours 8:30~22:00
■Facility Rental Hours 9:00~22:00

■Facility Usage Hours

General Reception & Ticket Sales 10:00~19:00
Rokkakudo Square(Open Hours) 7:30~22:30
Community Salon "Katachi no mori" 9:00~19:00

〈Parking(109cars)〉 7:30~22:30



※To access the underground parking, turn at the "Yubin Kyoku-mae" (Post Office) traffic signal toward Kurume City Plaza. The entrance ramp to the underground parking is immediately on the left.
※Parking is unavailable from 10:30 PM to 7:30 AM and on days when the plaza is closed.
※Maximum vehicle height: 3.2 meters.

〈Bicycle Parking〉 7:30~22:30



Car Drop-Off Area 7:30~22:30



※This area is designated for visitor drop-offs and pick-ups.
※Maximum vehicle height: 3.0 meters.
※Vans and Microbuses are permitted for use in this area.